

WATER

SNYDER INDUSTRIES INC.

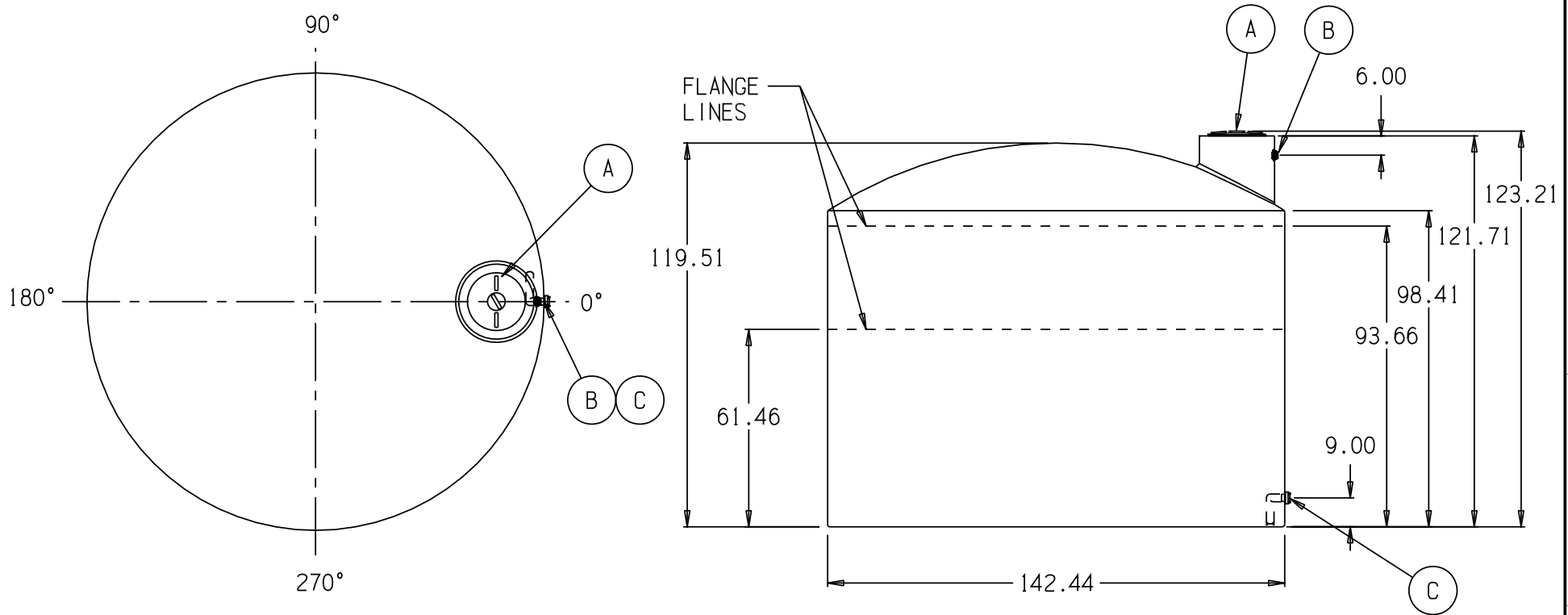

- A. 18" PE THREADED-VENTED MANWAY W/15" ACCESS [P/N 34700087]
- B. 1-1/2" PE SII THREADED BH FTG W/EPDM GASKET [P/N 34300008]
- C. 2" PP DBL FLANGED BOLTED LONG SIPHON TUBE ASSY W/EPDM GASKETS & SS BOLTS [P/N 34700841]

* BASE FITTINGS TO BE LEFT INSTALLED AT TIME OF SHIPMENT PER SII PROCEDURE
 ALL DIMENSIONS, DESIGNS, AND INFORMATION ON THIS PRINT MUST BE CONSIDERED PROPRIETARY TO SNYDER INDUSTRIES, INC.
 AND MAY NOT BE USED, COPIED, OR DISTRIBUTED WITHOUT WRITTEN PERMISSION OF AN OFFICER (OR HIS AGENT) OF THE FIRM.

(all dimensions in inches)
 PART # TANK: 5300200W94201 & 99801
 HDLPE/BLK & GDO/WATER

7,600 GALLON BLACK & DARK OLIVE GREEN WATER TANK

REF#: 00000 01/08/13